

# 430HS - MARINE GEARBOX

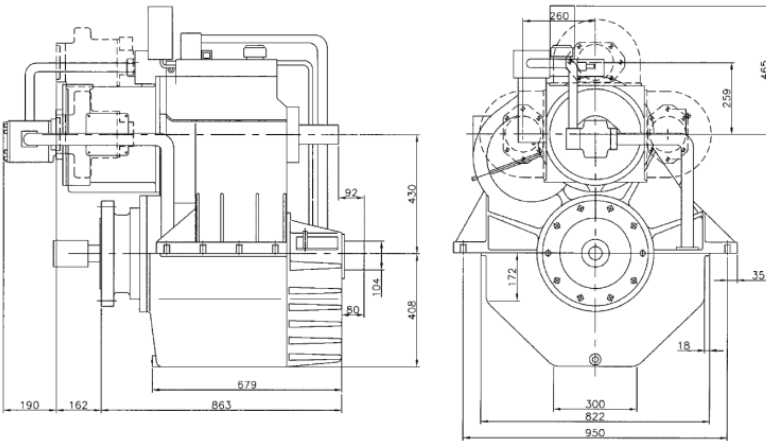

Reduction Ratio	Power Factor kW/RPM	Input Shaft Diameter mm
1,56-2,04-2,48-3,12-3,48:1	0,690	80
4,15-4,45-5,12:1	0,690	80
5,44:1	0,613	80
4,56-5,04:1	0,540	70
5,56:1	0,540	70
5,87:1	0,530	70
6,53:1	0,460	70

#### Servo for CP Propeller:

Max force = 200 kN  
Max stroke = 124 mm

#### PTO:

PTO with SAE D-flange and 14 tooth 1 ¼" involute inside spline  
Other SAE and ISO flanges and splines available  
Free shaft end also available  
Max torque from PTO: 900 Nm

#### Weight:

Approx. 1340 kg plus approx. 40 kg per PTO

#### Gearbox:

- Built-in servo system for CP propeller
- Compact design
- Large economical reduction ratio
- Option of 1, 2 or 3 PTOs each with own hydraulic clutch
- Rigid cast iron housing
- Helical ground gearwheels in casehardened and highly alloyed steel
- Hydraulic multi-plate clutch
- Oil system with direct driven oil pump, cooler, filter, valves etc.
- Pressure lubricated spherical roller bearings
- Designed according to the rules of the classification societies
- Each gearbox is tested and approved in test bed

#### Variants:

430-2HS 2-step gearbox for high reduction ratios

Manufacturer of **mekanord** gearboxes

For further details and additional information,  
please contact our technical sales organization

sales@meproduction.dk