

430-2HS - MARINE GEARBOX

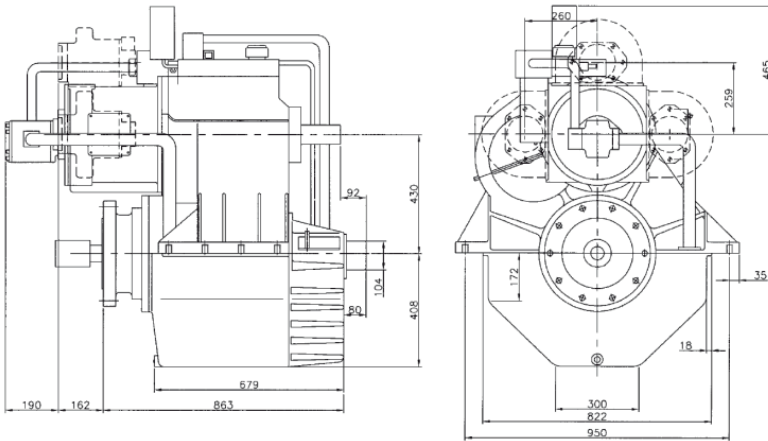

Reduction Ratio	Power Factor kW/RPM	Input Shaft Diameter mm
6,11:1	0,575	80
7,08:1	0,540	70
7,31:1	0,508	70
8,00:1	0,495	70
9,14:1	0,436	70

Servo for CP Propeller:

Max force = 200 kN
Max stroke = 124 mm

PTO:

PTO with SAE C-flange and 14 tooth 1 1/4" involute inside spline
Other SAE and ISO flanges and splines available
Free shaft end also available
Max torque from PTO: 900 Nm

Weight:

Approx. 1440 kg plus approx. 40 kg per PTO

Gearbox:

- Built-in servo system for CP propeller
- Compact design
- Large economical reduction ratio
- Option of 1, 2 or 3 PTOs each with own hydraulic clutch
- Rigid cast iron housing
- Helical ground gearwheels in casehardened and highly alloyed steel
- Hydraulic multi-plate clutch
- Oil system with direct driven oil pump, cooler, filter, valves etc.
- Pressure lubricated spherical roller bearings
- Designed according to the rules of the classification societies
- Each gearbox is tested and approved in test bed

Variants:

430HS 1-step gearbox for lower reduction ratios

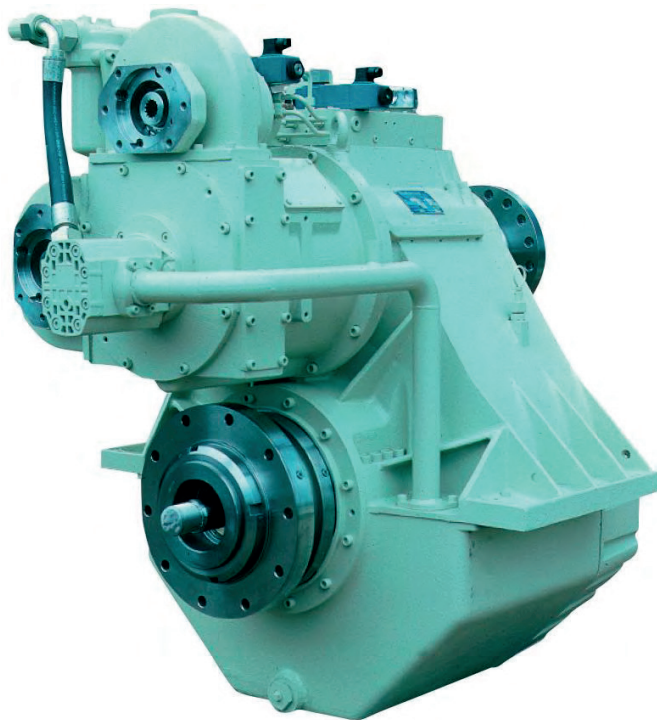

Manufacturer of **mekanord** gearboxes

For further details and additional information,
please contact our technical sales organization

sales@meproduction.dk